

# AVAILABLE

3649 N. 35<sup>th</sup> Avenue  
2,370 Sq. Ft.

## Features:

- Located just min. from I-10 & I-17 freeways
- 1,600 sq. ft. a/c office area (Open showroom, 2 offices & 2 RR)
- 770 sq. ft. +/- evap. cooled warehouse
- 14' Minimum clear height
- One (1) 12' x 12' grade door
- A-2 Zoning, City of Phoenix
- Excellent accessibility
- 200 amps, 120/208 volt, 3 phase power
- 35<sup>th</sup> Avenue Frontage
- **Competitive Gross Rental Rates**



5100 N. 40<sup>th</sup> Street  
Phoenix, Arizona 85018  
(602) 438-8000  
(602) 438-7940 fax  
[www.azindprop.com](http://www.azindprop.com)

For More Information Contact:

**Randy S. Warner**  
**(602) 438-8000**  
[randy@azindprop.com](mailto:randy@azindprop.com)

**5% Commission - Flat Lease Rates - No CAM's**

The information contained herein has been obtained from sources we deem reliable. However, no warranties or representations, expressed or implied, are made as to the accuracy of any information contained herein, and the information is subject to errors and omissions. This information is also subject to change of price, rental or other conditions, withdrawal without notice, and to any special listing conditions imposed by our principals.

12' x 12' Grade Door

Warehouse

10' x 12'

10' x 12'

21 x 50'

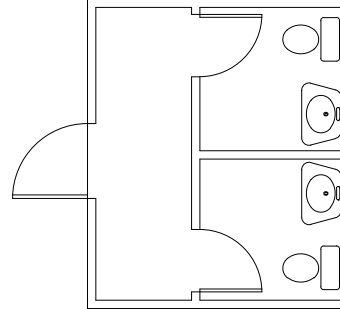

Drawing Not To Scale  
For Reference Only

3649 N. 35th Avenue  
Approx. 2,370 Sq. Ft.